

10BASE-T INTERFACE TRANSFORMER

Reinforced Insulation Per EN 41003/EN 60950

Turns Ratio ($\pm 5\%$)

1CT:1CT

Parameter	Min.	Max.	Units
Open Circuit Inductance	200		μH
Leakage Inductance		0.8	μH
Interwinding Capacitance (C_{WW})		15	pF
Primary DC Resistance		0.4	ohms
Secondary DC Resistance		0.5	ohms
Isolation (HI-POT)	4000		V_{RMS}

Meets IEE 802.3 and ANSI X3.263 Standards.

Transformer can be used for Transmit or Receive side.

Flammability: Materials used in the production of these units meet requirements of UL94-VO and IEC 695-2-2 needle flame test.

0.5mm minimum insulation thickness between primary and secondary.

Parts shipped in anti-static tubes.
31 pieces per tube

OPERATING TEMPERATURE RANGE:
-40°C TO +85°C

Physical Dimensions
inches (mm)

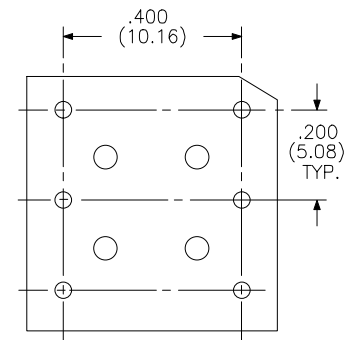
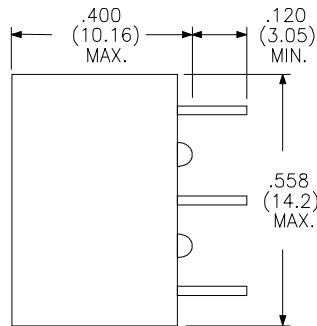
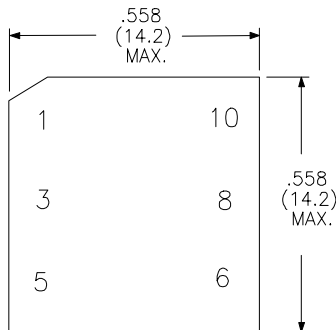

Schematic Diagram

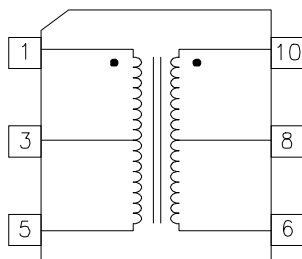

Leads are #22 AWG solderable

PRELIMINARY!

RHOMBUS P/N: **T-1482**

CUST P/N:

NAME:

DATE: **10/05/01**

SHEET: 1 OF 1